



Posi-Turner®



Rotates and Positions Your Product Safely, Efficiently, and Damage Free.

The Posi-Turner® is designed for . . .

Safety & Ergonomics

- Provides safer working conditions by positioning the work piece at a distance.
- Eliminates tipping or dropping work pieces and the shock load to the crane associated with using two cranes to roll over a heavy object.
- Allows you to stop or start rotations at any point.
- Makes it easier to position a work piece.
- Provides ergonomic benefits to employees performing production and assembly work.
- Meets or exceeds industry standards, including ASME B30.20, ASME BTH-1, AWS D1.1 and ANSI/NFPA 70.

Efficiency

- Lifts, levels and rotates objects without re-rigging.
- Improves Production process efficiency, by keeping an assembly line moving.
- Makes rotation, positioning and precision work easier.
- Require only one operator for system rotation.
- Saves production time and labor time.

Damage-Free Product Quality

- Eliminates product slipping and dropping.
- Reduces product damage.



Posi-Turner® Applications . . .

- **Transportation** - Auto: frames, engines, dies, molds, etc. chassis, trailers, tanks, etc. Rail: undercarriages, bogeys, cars, wheels, etc. Aircraft-Aerospace: panels, tooling, etc. Shipping: container and trailer, etc.
- **Industrial Equipment** - machine bases, panels, enclosures, engine blocks, weldments and frames.
- **Heavy Equipment** - Agricultural, Construction, Mining, Military: chassis, axles, assemblies, buckets, transmissions, frames and booms, etc.
- **Concrete** - Precast Molds: vaults, pipes, basins, barriers, construction girders, panels and decks, etc.
- **Marine** - decks, hulls, panels and molds, etc.
- **Plastics/Composites** - injection molds and fiberglass products, etc.
- **Metal Forming** - tooling, dies, coils, castings and sheets, etc.
- **Materials Production** - blocks, slabs, ingots, plates, bundles, stone, steel, aluminum, stainless, ceramics, copper, graphite, refractory, paper and wood, etc.
- **Specialty Products**

BELOW THE HOOK





“Tea Cup” Pipe Carrier



PRODUCT FEATURES:

- An efficient way to handle concrete water and sewer pipes
- The Caldwell “Tea Cup” Pipe Carrier will save you time and money
- Three sizes available to handle from 3/4” to 1-1/2” cable and lift up to 18 tons
- Optional “Spoon Handle” allows the PC-3/4 “Tea Cup” to be guided into small diameter pipes

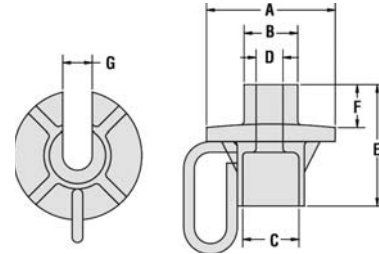

Model Number	Rated Capacity (tons)	Sling Dia. (in.)	Dimensions (in.)							Weight (lbs)
			A	B	C	D	E	F	G	
PC-3/4	6.6	3/4 7/8	5.56	2	2.13	1.13	4.75	1.75	1.13	9
PC-1	13	11-1/8 1-1/4	6	2.50	2.63	1.38	5.75	1.75	1.38	12
PC-1-1/2	18	1-1/2	8	3	3.25	1.63	7.63	2.75	1.63	22

Use With	Model Number	Rated Capacity (tons)	Sling Dia. (in.)	Standard Length (ft)	After Swage Dim. (in)		Weight (lbs)
					A	B	
PC-3/4	LS-3/4	4.9	3/4	5	3.25	1.55	9
	LS-7/8	6.6	7/8	5	3.86	1.80	14
PC-1	LS-1	8.5	1	5	4.36	2.05	19
	LS-1-1/8	10	1-1/8	5	4.81	2.30	26
	LS-1-1/4	13	1-1/4	5	5.42	2.56	33
PC-1-1/2	L-1-1/2	18	1-1/2	5	6.52	3.00	52

“Corky” Container Lifting Lugs

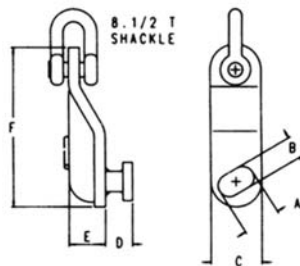

RIGHT HAND SHOWN

PRODUCT FEATURES:

- An efficient way to lift containers from bottom lifting slot
- Color is identified to separate left and right handed “Corky” lugs
- Handle indicator shows lug is engaged for lift
- Complies with ASME Standards

PRODUCT OPTIONS:

- 8-1/2 ton shackle code-S

Model Number	Rated Capacity (tons)	Corky Hook Dimensions (in.)						Color		Weight (lbs)
		A	B	C	D	E	F	Right Hand	Left Hand	
LL	8-1/2	3	1-3/4	4	2	2-7/8	12-3/4	Yellow	Red	17