

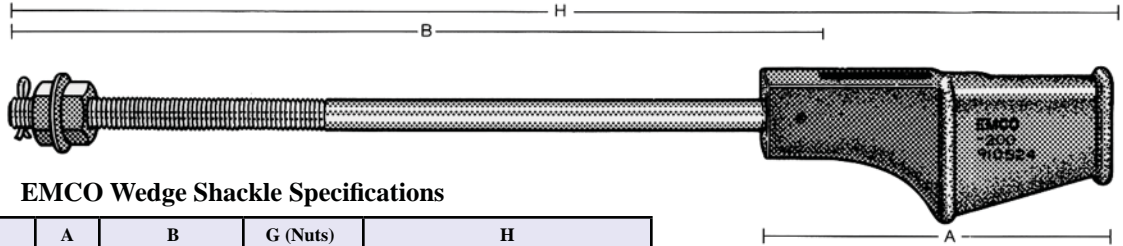

## EMCO Elevator Shackles

**EMCO Series 100, 200, 400, and 500 Wedge Rope Shackles** are tested with IWRC INNER WIRE ROPE CORE TRACTION STEEL elevator rope and exceed ANSI A17.1 Section 2.20-2000 Safety Code. All rod threads are rolled for greater tensile strength in the thread area. Standard rod lengths are listed below. Other rod and thread lengths are available. All standard wedge sockets are painted black. Special colors, finishes, or other non-standard features are available as are metric threads. All sockets come with cotter pin, washer, and two (2) nuts as standard.



**EMCO Wedge Shackle Specifications**

Wedge Socket	A	B	G (Nuts)	H
EM 100 (3/8" - 10mm)	6	12,18,24	1/2-13 UNC	17, 23, 29
EM 200 (7/16" - 13mm)	7.5	12,18,24,30,36,42	3/4-10 UNC	18.25, 24.25,30.25,36.25,42.25,48.25
EM 400 (11/16" - 19 mm)	9	12,18,24,30,36,42	7/8-9 UNC	19.5,25.5,31.5,37.5,43.5,49.5
EM 500 (13/16" - 22 mm)	12	24,30,36,42,48	1-3/8-6 UNC	34.5,40.5,46.5,52.5,58.5

### RETAINING CLIPS



**Retaining Clip Specifications**

Retaining Clip	N	O	P	Nut Size	Bolt Size
EM 103 (3/8" - 10 mm)	7/8	1.61	0.7	M6	M6 x 35 mm
EM 203 (7/16" - 16 mm)	7/8	1.88	0.94	M6	M6 x 35 mm
EM 403 (11/16" - 19 mm)	1	2.25	1.06	M6	M6 x 40 mm
EM 503 (13/16" - 22 mm)	1-3/16	2.84	1.42	M6	M6 x 45 mm

### Wedge Insert Specifications

Wedge Insert	L	Color
EM 101 (3/8" - 10 mm)	3.74	Black
EM 201A (7/16" - 13 mm)	4.00	Blue
EM 202 (9/16" - 16mm)	4.70	Red
EM 401 (11/16" - 19 mm)	5.51	Yellow
EM 501 (13/16" - 22 mm)	6.79	Purple

### WEDGE INSERT

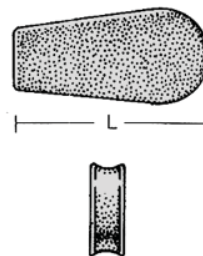

### EMCO Elevator Rope Shackles

- Performance tested to exceed requirements of ANSI A17.1 Section 2.20-2000 using IWRC Inner Wire Rope Core Traction Steel Elevator Rope.
- Safer than handling molten babbitt or chemicals
- Installation methods are easier to teach
- Proven in thousands of applications
- Save over 50% on cost and labor versus babbitt and resin socketing
- Easy, consistent installation
- Simple adjustment procedure for shortening ropes
- Easy method of inspection to assure correct installation
- Exceeds all OEM Specifications

**NOTE:** Actual Dimensions and specifications of the products listed on this page and the following page may change without notice to conform with the most recent regulations and standards.



### EMCO Governor Shackles

EM100G and EM200G wedge rope shackles are designed for use on governor ropes.

The EM100G is designed for 3/8" - 10 mm ropes and the EM200G is designed for 7/16" - 16 mm ropes. Governor Rope Shackles should be purchased with wedge inserts and retaining clips as previously shown.

In addition, Part Number EM100/200G Bolt Assembly can be ordered. This item consists of bolt, nut, and cotter pin to insert through the eye in casting and allows for securing the socket to the governor.

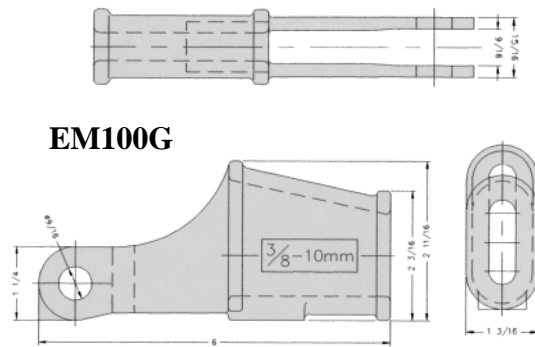
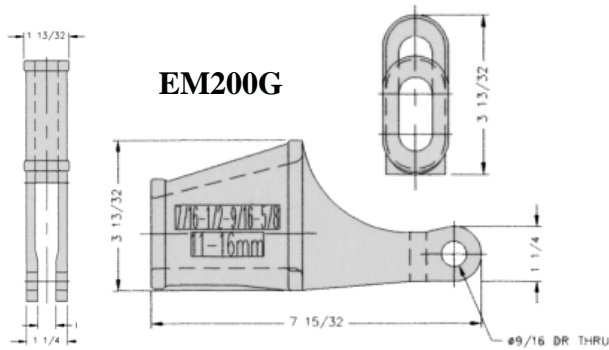

### EMCO Babbitt Shackles

EMCO Babbitt Shackles are forged, normalized, and tempered. Standard units are painted black and come with cotter pin, washer, and two (2) nuts.

Special colors, finishes, and other non-standard features are available.

Babbitt Socket Specifications

Babbitt Socket	Size	A	B	G (Nuts)
Em 4 (1/2" Rope)	1/2 x 18	6	18	3/4-10 UNC
EM 5 (1/2" Rope)	1/2 x 24	6	24	3/4-10 UNC
EM 7 (5/8" Rope)	5/8 x 18	7	18	7/8-9 UNC
EM 8 (5/8" Rope)	5/8 x 24	7	24	7/8-9 UNC



### Spring Isolation Bushing Assemblies

Spring Isolation Bushing Assemblies provide:

- Equal tension on all wire ropes
- Isolation of all metal parts between sockets, springs, and hitch plate for noiseless operation.

Spring Isolation Bushing Assemblies are provided complete with springs, bushings, and washers specifically sized for the speed and capacity of the elevator.

Three basic models: EM 901, EM 1001, EM 1101. Other models are available for heavy duty and high rise cars.

